

- Legend:**
- City Boundary
  - Proposed Development Boundary
  - Proposed Road Development
  - Structure (S)
  - Proposed Culvert (C)
  - Proposed Mammel Underpass (C)
  - Proposed Attenuation Pond / Infiltration Basin / Wetlands
  - Proposed Stream Diversion
- Proposed Road Lighting**
- Lantern Type A  
9430 lm LED mounted on 10m high columns
  - Lantern Type B  
5410 lm LED mounted on 10m high columns
  - Lantern Type C  
5410 lm LED mounted on 10m high columns
  - Lantern Type D  
11760 lm LED mounted on 12m high columns
  - Floodlight Type E  
9380 lm LED mounted at 6m
- Proposed Road Lighting Isolines**
- Isoline 1.0 lux
  - Isoline 2.0 lux
  - Isoline 5.0 lux
  - Isoline 10 lux
  - Isoline 15 lux
  - Isoline 25 lux
- AR** - Access Road  
**R** - Retaining Wall

For Continuation see Dwg. No. Figure 5.4.12

San áiríúmh tá sonraíocht Shuirbhéireacht Ordánais Éireann arna áitirgeadh fíor Cheadúnas OSI Uimh. 2010/20CCMA/Comhairle Contae na Gaillimhe. Sárúinn áitirgeadh neamhdáraithe cóipeacht Shuirbhéireacht Ordánais Éireann agus Rialtas na hÉireann. © Suirbhéireacht Ordánais Éireann, 2010.

© Suirbhéireacht Ordánais Éireann. Gach ceart ar chosaint. Uimhir cheadúnais 2010/20CCMA/Comhairle Contae na Gaillimhe.

Includes Ordnance Survey Ireland data reproduced under OSI Licence number 2010/20CCMA/Galway County Council. Unauthorised reproduction infringes Ordnance Survey Ireland and Government of Ireland copyright. © Ordnance Survey Ireland, 2010.

© Ordnance Survey Ireland. All rights reserved. Licence number 2010/20CCMA/Galway County Council.

Clients

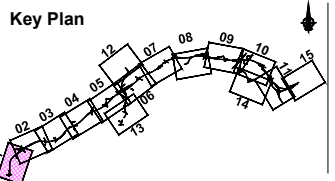

Consultant

Corporate House  
City East Business Park  
Ballybrit, Galway, Ireland.

Tel +353 (0)91 460675  
www.N6GalwayCity.ie  
www.arup.ie

Job Title  
**N6 Galway City Ring Road**

Scale  
1:5000 @ A3

Date:  
September 2018

Issue	Date	By	Chkd	Appd
I2	10/02/2020	KJ	HK	EMC
I1	28/09/2018	KJ	JD	EMC

Drawing Title  
**Road Lighting Columns and Brackets Location**  
CH.0+000 to CH.1+350  
Sheet 1 of 15

Drawing Status  
**For Information**

Job No <b>233985</b>	Drawing No <b>Figure 5.4.01</b>	Issue <b>12</b>
-------------------------	------------------------------------	--------------------



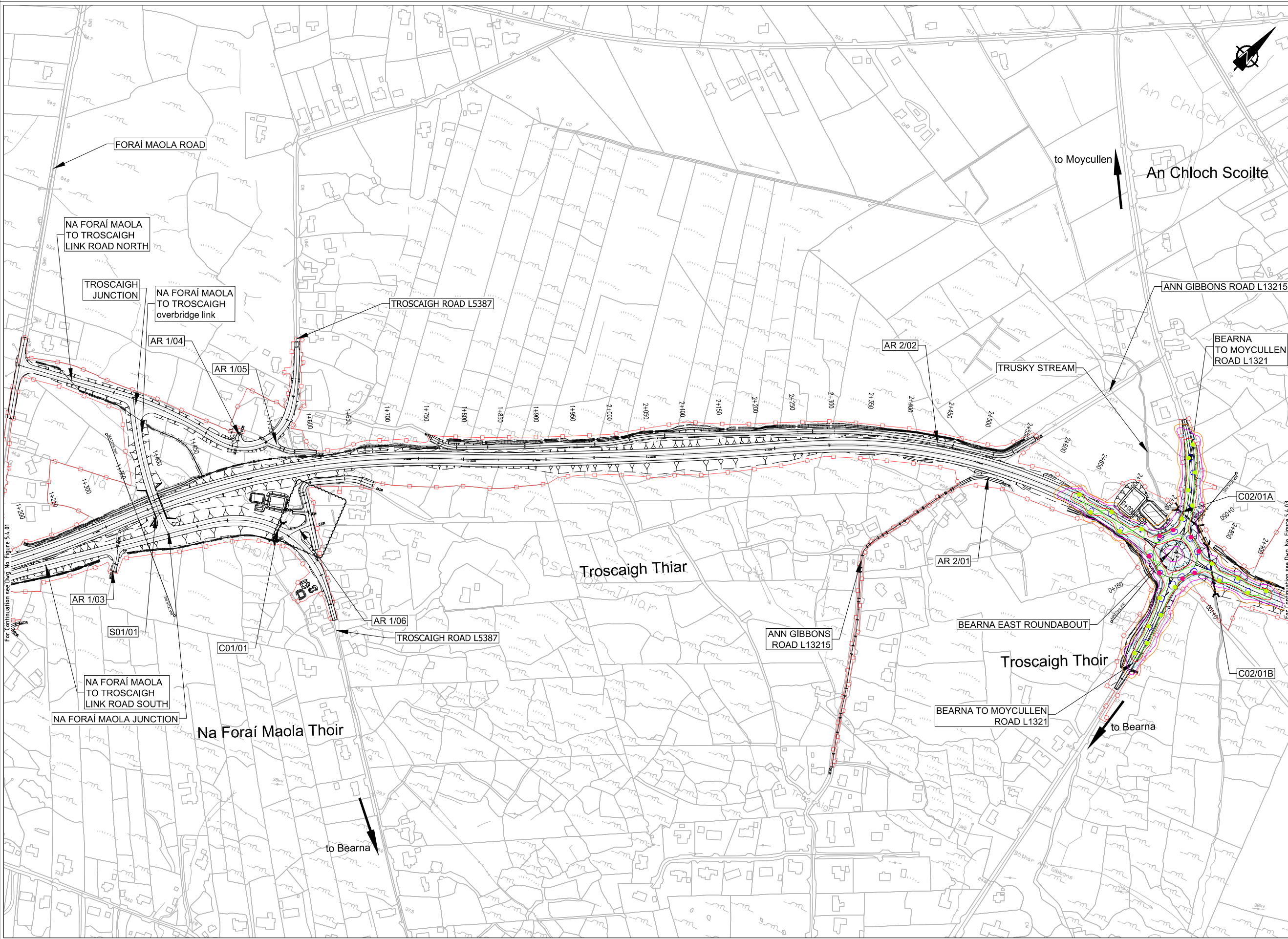

- Legend:**
- City Boundary
  - Proposed Development Boundary
  - Proposed Road Development
  - Structure (S)
  - Proposed Culvert (C)
  - Proposed Mammel Underpass (C)
  - Proposed Attenuation Pond / Infiltration Basin / Wetlands
  - Proposed Stream Diversion
- Proposed Road Lighting**
- Lantern Type A: 9430 lm LED mounted on 10m high columns
  - Lantern Type B: 5410 lm LED mounted on 10m high columns
  - Lantern Type C: 5410 lm LED mounted on 10m high columns
  - Lantern Type D: 11760 lm LED mounted on 12m high columns
  - Floodlight Type E: 9380 lm LED mounted at 6m
- Proposed Road Lighting Isolines**
- Isoline 1.0 lux
  - Isoline 2.0 lux
  - Isoline 5.0 lux
  - Isoline 10 lux
  - Isoline 15 lux
  - Isoline 25 lux
- AR** - Access Road  
**R** - Retaining Wall

San áiríúmh tá sonraíochtaí Shuirbhéireachtaí Ordánais Éireann arna aistriú go dtí físeán Chéadainn OSI Uimh. 2010/20CCMA/Comhairle Contae na Gaillimhe. Sáráilonn aistriú go dtí físeán na cópáir Shuirbhéireachtaí Ordánais Éireann agus Rialtas na hÉireann. © Suirbhéireachtaí Ordánais Éireann, 2010.

© Suirbhéireachtaí Ordánais Éireann. Gach ceart ar chosaint. Uimhir cheadainn 2010/20CCMA/Comhairle Contae na Gaillimhe.

Includes Ordnance Survey Ireland data reproduced under OSI Licence number 2010/20CCMA/Galway County Council. Unauthorised reproduction infringes Ordnance Survey Ireland and Government of Ireland copyright. © Ordnance Survey Ireland, 2010.

© Ordnance Survey Ireland. All rights reserved. Licence number 2010/20CCMA/Galway County Council.

Clients

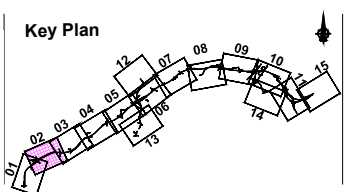

Consultant

Corporate House  
City East Business Park  
Ballybrit, Galway, Ireland.

Tel +353 (0)91 460675  
www.N6GalwayCity.ie  
www.arup.ie

Job Title  
**N6 Galway City Ring Road**

Scale  
1:5000 @ A3

Date:  
September 2018

Issue	Date	By	Chkd	Appd
I2	10/02/2020	KJ	HK	EMC
I1	28/09/2018	KJ	JD	EMC

Drawing Title  
**Road Lighting Columns and Brackets Location**  
CH.14-350 to CH.2+799  
Sheet 2 of 15

Drawing Status  
**For Information**

Job No  
**233985**

Drawing No  
**Figure 5.4.02**

Issue  
**I2**



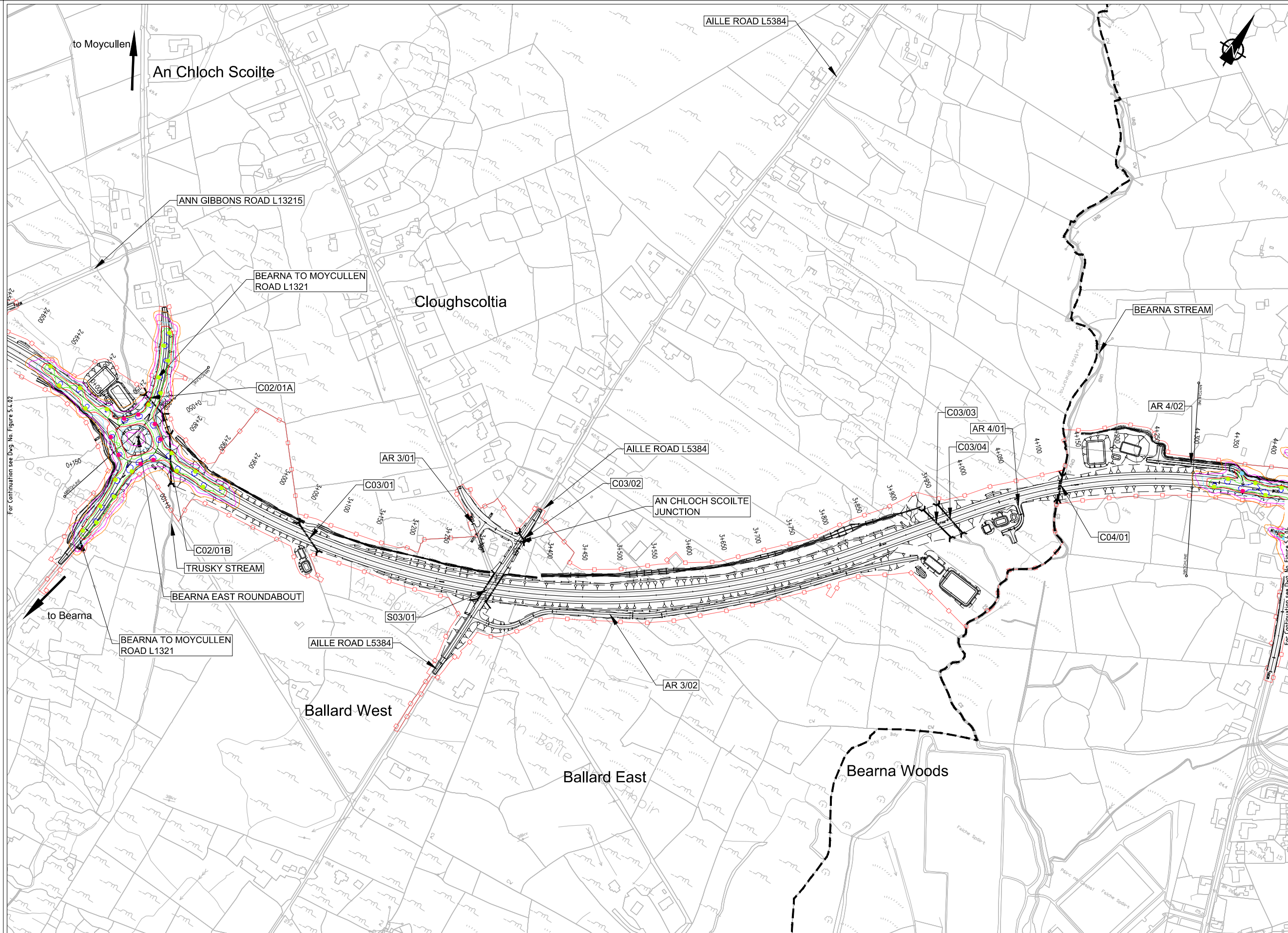

**EIA REPORT**

**Legend:**

- City Boundary
- Proposed Development Boundary
- Proposed Road Development
- Structure (S)
- Proposed Culvert (C)
- Proposed Mammel Underpass (C)
- Proposed Attenuation Pond / Infiltration Basin / Wetlands
- Proposed Stream Diversion

**Proposed Road Lighting**

- Lantern Type A: 9430 lm LED mounted on 10m high columns
- Lantern Type B: 5410 lm LED mounted on 10m high columns
- Lantern Type C: 5410 lm LED mounted on 10m high columns
- Lantern Type D: 11760 lm LED mounted on 12m high columns
- Floodlight Type E: 9380 lm LED mounted at 6m

**Proposed Road Lighting Isolines**

- Isoline 1.0 lux
- Isoline 2.0 lux
- Isoline 5.0 lux
- Isoline 10 lux
- Isoline 15 lux
- Isoline 25 lux

**AR** - Access Road  
**R** - Retaining Wall

San áiríúmh tá sonraíochtaí Shairbhéiríochtaí Ordánais Éireann arna aistriúgeadh fíor Cheadúnas OSI Uimh. 2010/20CCMA/Comhairle Contae na Gaillimhe. Sárúilíon aistriúgeadh neamhdáraithe cóipeacht Shairbhéiríochtaí Ordánais Éireann agus Rialtas na hÉireann. © Sairbhéiríochtaí Ordánais Éireann, 2010.

© Sairbhéiríochtaí Ordánais Éireann. Gach ceart ar chosaint. Uimhir cheadúnais 2010/20CCMA/Comhairle Contae na Gaillimhe.

Includes Ordnance Survey Ireland data reproduced under OSI Licence number 2010/20CCMA/Galway County Council. Unauthorised reproduction infringes Ordnance Survey Ireland and Government of Ireland copyright. © Ordnance Survey Ireland, 2010.

© Ordnance Survey Ireland. All rights reserved. Licence number 2010/20CCMA/Galway County Council.

Clients

An Roinn Iompair Turasoireachta agus Spóirt  
Department Transport, Tourism and Sport

Project Ireland 2040  
The National Development Plan

Galway City Transport Project

Comhairle Chontae na Gaillimhe  
Galway County Council

TIIV  
Transport Infrastructure Ireland

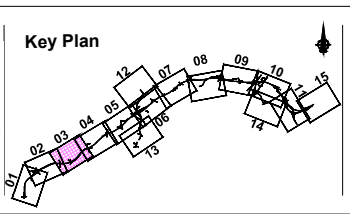

Consultant

**ARUP**

Corporate House  
City East Business Park  
Ballybrit, Galway, Ireland.

Tel +353 (0)91 460675  
www.N6GalwayCity.ie  
www.arup.ie

Job Title  
**N6 Galway City Ring Road**

Scale  
1:5000 @ A3

Date:  
September 2018

Issue	Date	By	Chkd	Appd
I2	10/02/2020	KJ	HK	EMC
I1	28/09/2018	KJ	JD	EMC

Drawing Title  
Road Lighting Columns and Brackets Location  
CH.2+799 to CH.4+300  
Sheet 3 of 15

Drawing Status  
**For Information**

Job No  
**233985**

Drawing No  
**Figure 5.4.03**

Issue  
**12**



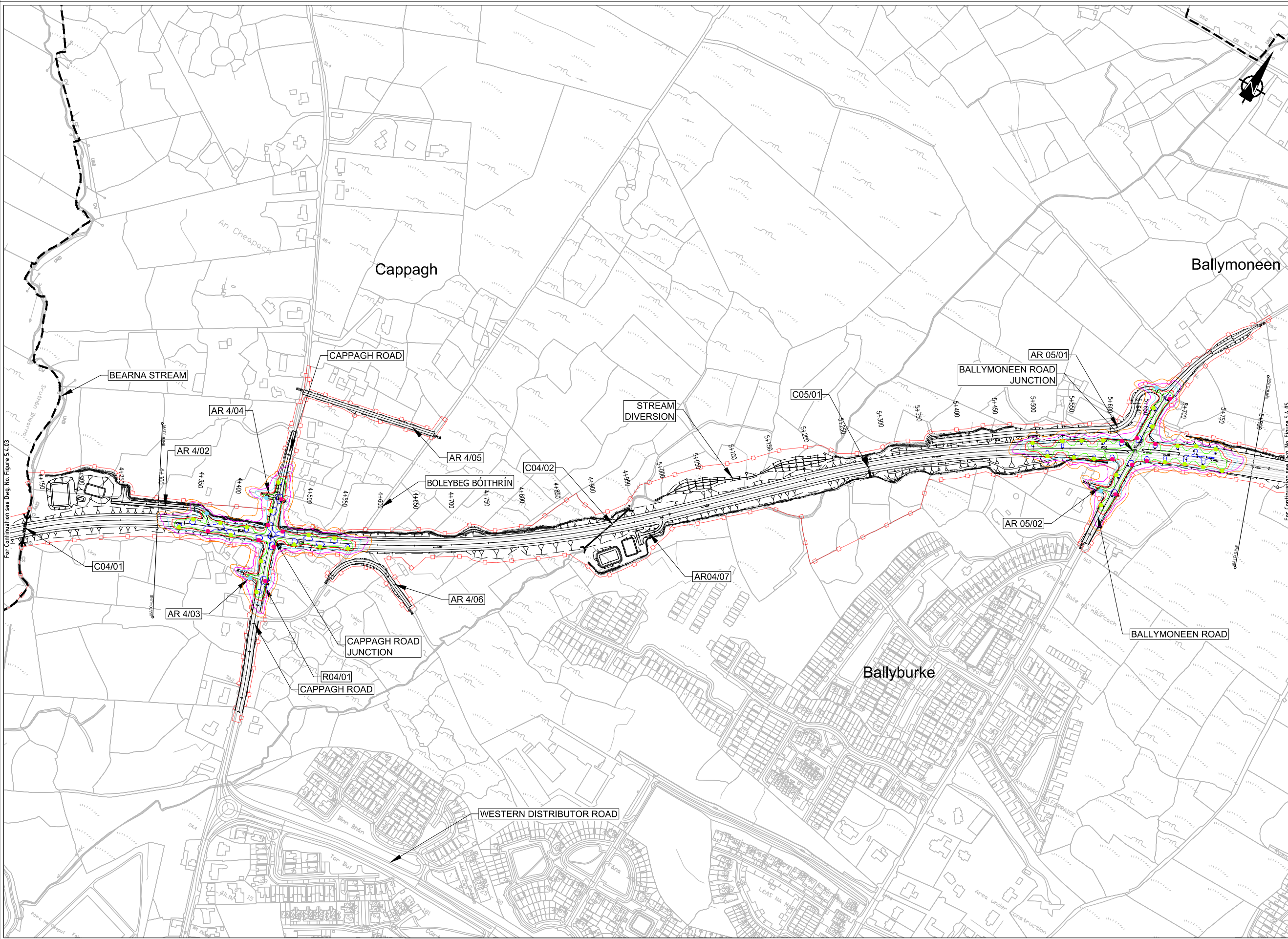

- Legend:**
- City Boundary
  - Proposed Development Boundary
  - Proposed Road Development
  - Structure (S)
  - Proposed Culvert (C)
  - Proposed Mammel Underpass (C)
  - Proposed Attenuation Pond / Infiltration Basin / Wetlands
  - Proposed Stream Diversion
- Proposed Road Lighting**
- Lantern Type A  
9430 lm LED mounted on 10m high columns
  - Lantern Type B  
5410 lm LED mounted on 10m high columns
  - Lantern Type C  
5410 lm LED mounted on 10m high columns
  - Lantern Type D  
11760 lm LED mounted on 12m high columns
  - Floodlight Type E  
9380 lm LED mounted at 6m
- Proposed Road Lighting Isolines**
- Isoline 1.0 lux
  - Isoline 2.0 lux
  - Isoline 5.0 lux
  - Isoline 10 lux
  - Isoline 15 lux
  - Isoline 25 lux
- AR** AR - Access Road
- R** R - Retaining Wall

Son áiríamh tá sonraíocht Shairbhéireacht Orlánais Éireann arna aistriú go dtí físeán OSI Uimh. 2010/20CCMA/Comhairle Contae na Gaillimhe. Sárúil ar aistriú go dtí neamhdátaíocht cóipeacht Shairbhéireacht Orlánais Éireann agus Rialtas na hÉireann. © Sairbhéireacht Orlánais Éireann, 2010.

© Sairbhéireacht Orlánais Éireann. Gach ceart ar chosaint. Uimhir cheadúnais 2010/20CCMA/Comhairle Contae na Gaillimhe.

Includes Ordnance Survey Ireland data reproduced under OSI Licence number 2010/20CCMA/Galway County Council. Unauthorised reproduction infringes Ordnance Survey Ireland and Government of Ireland copyright. © Ordnance Survey Ireland, 2010.

© Ordnance Survey Ireland. All rights reserved. Licence number 2010/20CCMA/Galway County Council.

Clients

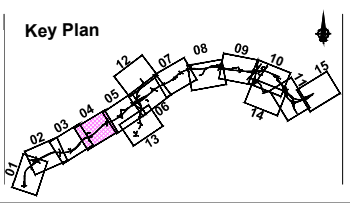

Consultant

Corporate House  
City East Business Park  
Ballybrit, Galway, Ireland.

Tel +353 (0)91 460675  
www.N6GalwayCity.ie  
www.arup.ie

Job Title  
**N6 Galway City Ring Road**

Scale  
1:5000 @ A3

Date:  
September 2018

Issue	Date	By	Chkd	Appd
I2	10/02/2020	KJ	HK	EMC
I1	28/09/2018	KJ	JD	EMC

Drawing Title  
**Road Lighting Columns and Brackets Location**  
CH.4+300 to CH.5+800  
Sheet 4 of 15

Drawing Status  
**For Information**

Job No <b>233985</b>	Drawing No <b>Figure 5.4.04</b>	Issue <b>I2</b>
-------------------------	------------------------------------	--------------------



Legend:

- City Boundary
- Proposed Development Boundary
- Proposed Road Development
- Structure (S)
- Proposed Culvert (C)
- Proposed Mammel Underpass (C)
- Proposed Attenuation Pond / Infiltration Basin / Wetlands
- Proposed Stream Diversion

Proposed Road Lighting

- Lantern Type A  
9430 lm LED mounted on 10m high columns
- Lantern Type B  
5410 lm LED mounted on 10m high columns
- Lantern Type C  
5410 lm LED mounted on 10m high columns
- Lantern Type D  
11760 lm LED mounted on 12m high columns
- Floodlight Type E  
9380 lm LED mounted at 6m

Proposed Road Lighting Isolines

- Isoline 1.0 lux
- Isoline 2.0 lux
- Isoline 5.0 lux
- Isoline 10 lux
- Isoline 15 lux
- Isoline 25 lux

AR - Access Road

R - Retaining Wall

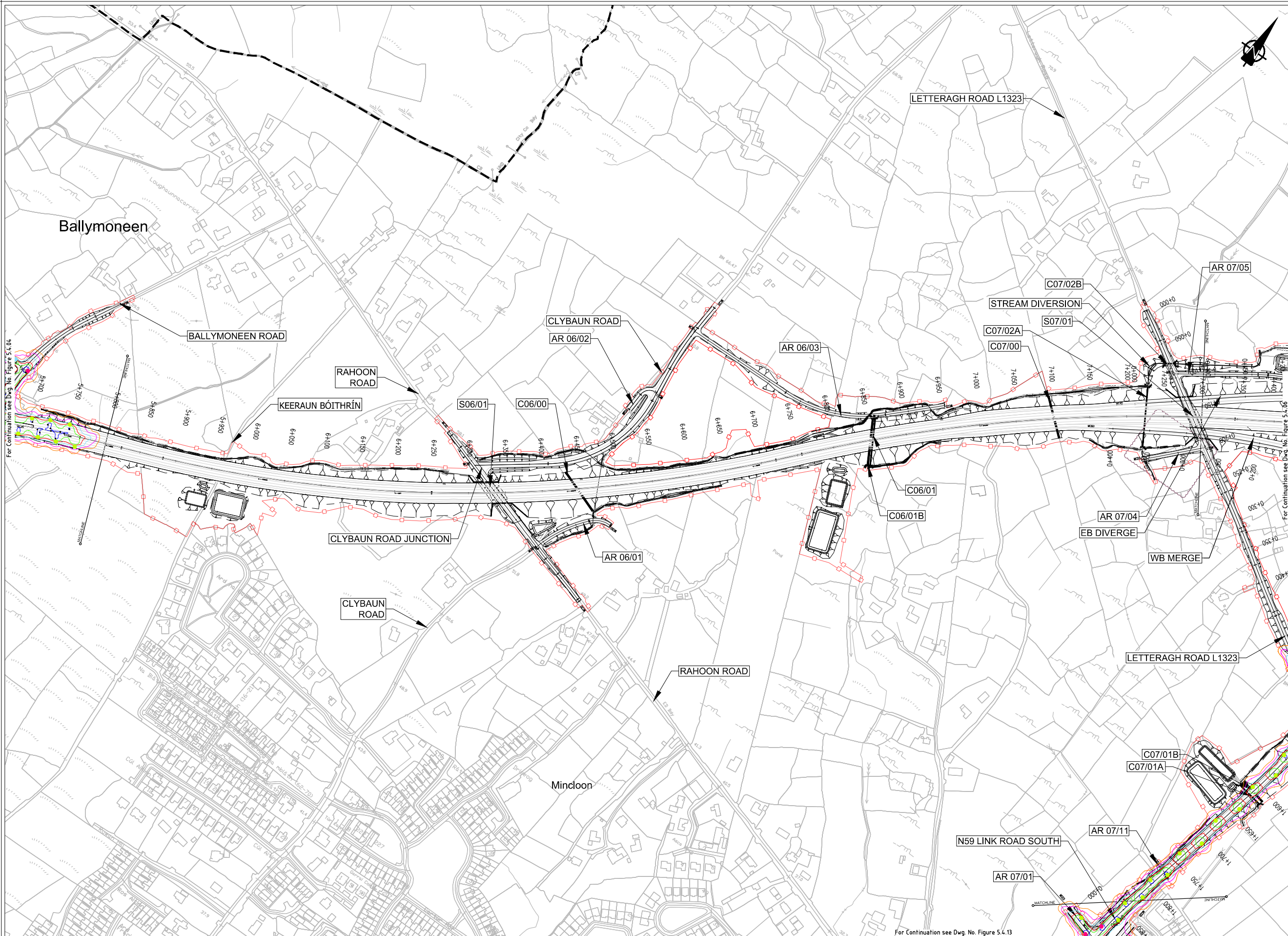

Sun áiríúmh tá sonraíocht Shairbhéiríochta Ordánais Éireann arna aistriúgeadh fíú Cheadúnas OSI Uimh. 2010/20CCMA/Comhairle Contae na Gaillimhe. Sárúinn aistriúgeadh neamháráithe cóipeacht Shairbhéiríochta Ordánais Éireann agus Rialtas na hÉireann. © Sairbhéiríochta Ordánais Éireann, 2010.

© Sairbhéiríochta Ordánais Éireann. Gach ceart ar chosaint. Uimhir cheadúnais 2010/20CCMA/Comhairle Contae na Gaillimhe.

Includes Ordnance Survey Ireland data reproduced under OSI Licence number 2010/20CCMA/Galway County Council. Unauthorised reproduction infringes Ordnance Survey Ireland and Government of Ireland copyright. © Ordnance Survey Ireland, 2010.

© Ordnance Survey Ireland. All rights reserved. Licence number 2010/20CCMA/Galway County Council.

Clients

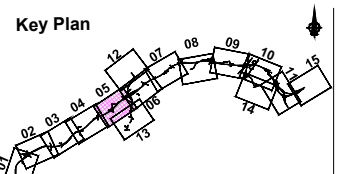

Consultant

Corporate House  
City East Business Park  
Ballybrit, Galway, Ireland.

Tel +353 (0)91 460675  
www.N6GalwayCity.ie  
www.arup.ie

Job Title  
**N6 Galway City Ring Road**

Scale  
1:5000 @ A3

Date  
September 2018

Issue	Date	By	Chkd	Appd
I2	10/02/2020	KJ	HK	EMC
I1	28/09/2018	KJ	JD	EMC

Drawing Title  
**Road Lighting Columns and Brackets Location  
CH.5+800 to CH.7+300  
Sheet 5 of 15**

Drawing Status  
**For Information**

Job No  
**233985**

Drawing No  
**Figure 5.4.05**

Issue  
**12**



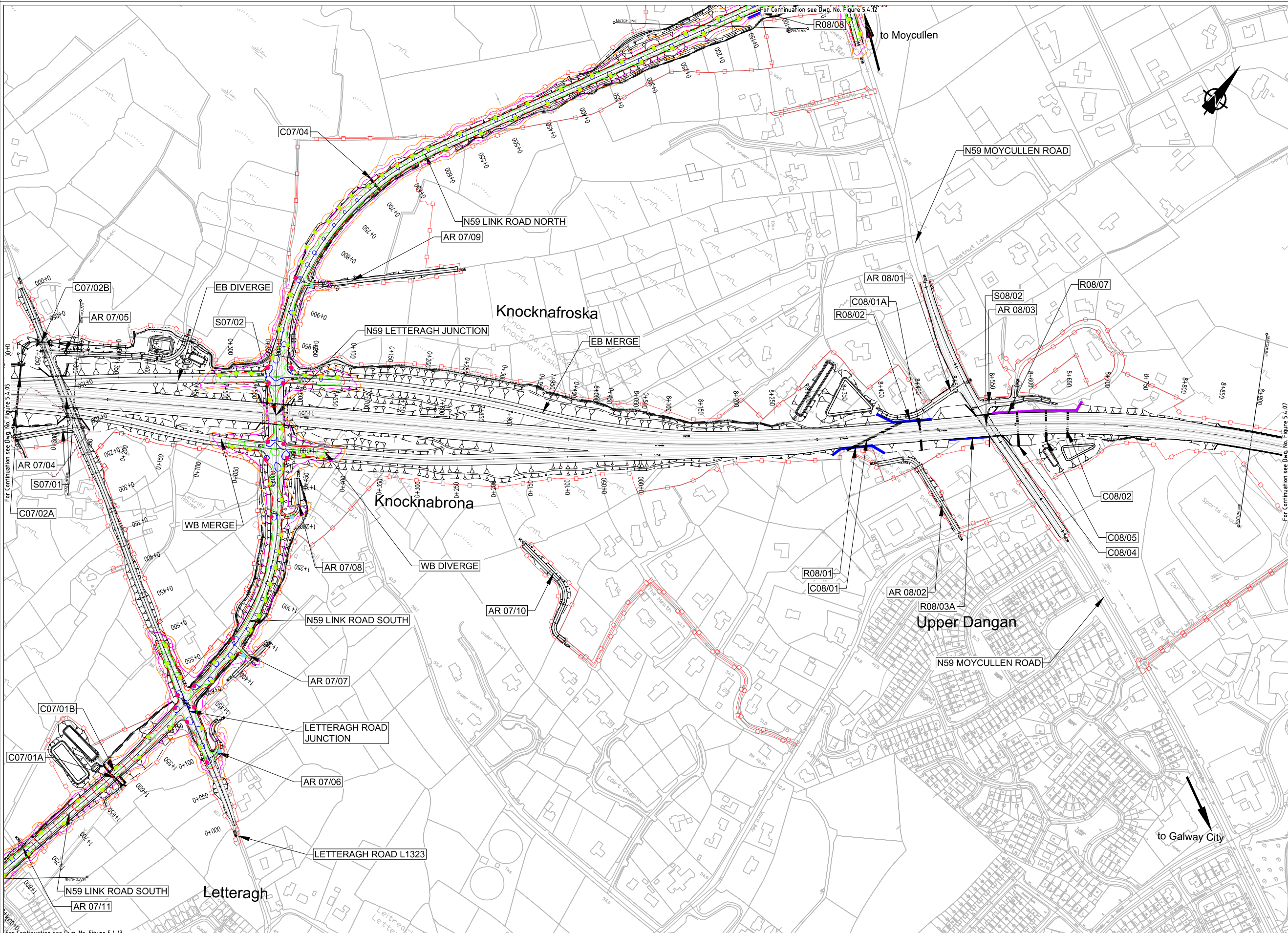

- Legend:**
- City Boundary
  - Proposed Development Boundary
  - Proposed Road Development
  - Structure (S)
  - Proposed Culvert (C)
  - Proposed Mammel Underpass (C)
  - Proposed Attenuation Pond / Infiltration Basin / Wetlands
  - Proposed Stream Diversion
- Proposed Road Lighting**
- Lantern Type A  
9430 lm LED mounted on 10m high columns
  - Lantern Type B  
5410 lm LED mounted on 10m high columns
  - Lantern Type C  
5410 lm LED mounted on 10m high columns
  - Lantern Type D  
11760 lm LED mounted on 12m high columns
  - Floodlight Type E  
9380 lm LED mounted at 6m
- Proposed Road Lighting Isolines**
- Isoline 1.0 lux
  - Isoline 2.0 lux
  - Isoline 5.0 lux
  - Isoline 10 lux
  - Isoline 15 lux
  - Isoline 25 lux
- AR** AR - Access Road
- R** R - Retaining Wall

San áiríúmh tá sonraíocht Shuirbhíreachtú Ordnáis Éireann arna aistriú go dtailíocht físe Chéadainn OSI Uimh. 2010/20CCMA/Comhairle Contae na Gaillimhe. Sáráilíonn aistriú go dtailíocht na cíoscheart Shuirbhíreachtú Ordnáis Éireann agus Rialtas na hÉireann. © Suirbhíreachtú Ordnáis Éireann, 2010.

© Suirbhíreachtú Ordnáis Éireann. Gach ceart ar chosaint. Uimhir cheadainn 2010/20CCMA/Comhairle Contae na Gaillimhe.

Includes Ordnance Survey Ireland data reproduced under OSI Licence number 2010/20CCMA/Galway County Council. Unauthorised reproduction infringes Ordnance Survey Ireland and Government of Ireland copyright. © Ordnance Survey Ireland, 2010.

© Ordnance Survey Ireland. All rights reserved. Licence number 2010/20CCMA/Galway County Council.

Clients

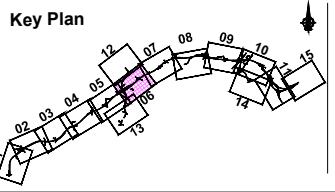

Consultant

Corporate House  
City East Business Park  
Ballybrit, Galway, Ireland.

Tel +353 (0)91 460675  
www.N6GalwayCity.ie  
www.arup.ie

Job Title  
**N6 Galway City Ring Road**

Scale  
1:5000 @ A3

Date  
September 2018

Issue	Date	By	Chkd	Appd
I2	10/02/2020	KJ	HK	EMC
I1	28/09/2018	KJ	JD	EMC

Drawing Title  
**Road Lighting Columns and Brackets Location**  
CH.7+300 to CH.8+900  
Sheet 6 of 15

Drawing Status  
**For Information**

Job No  
**233985**

Drawing No  
**Figure 5.4.06**

Issue  
**I2**



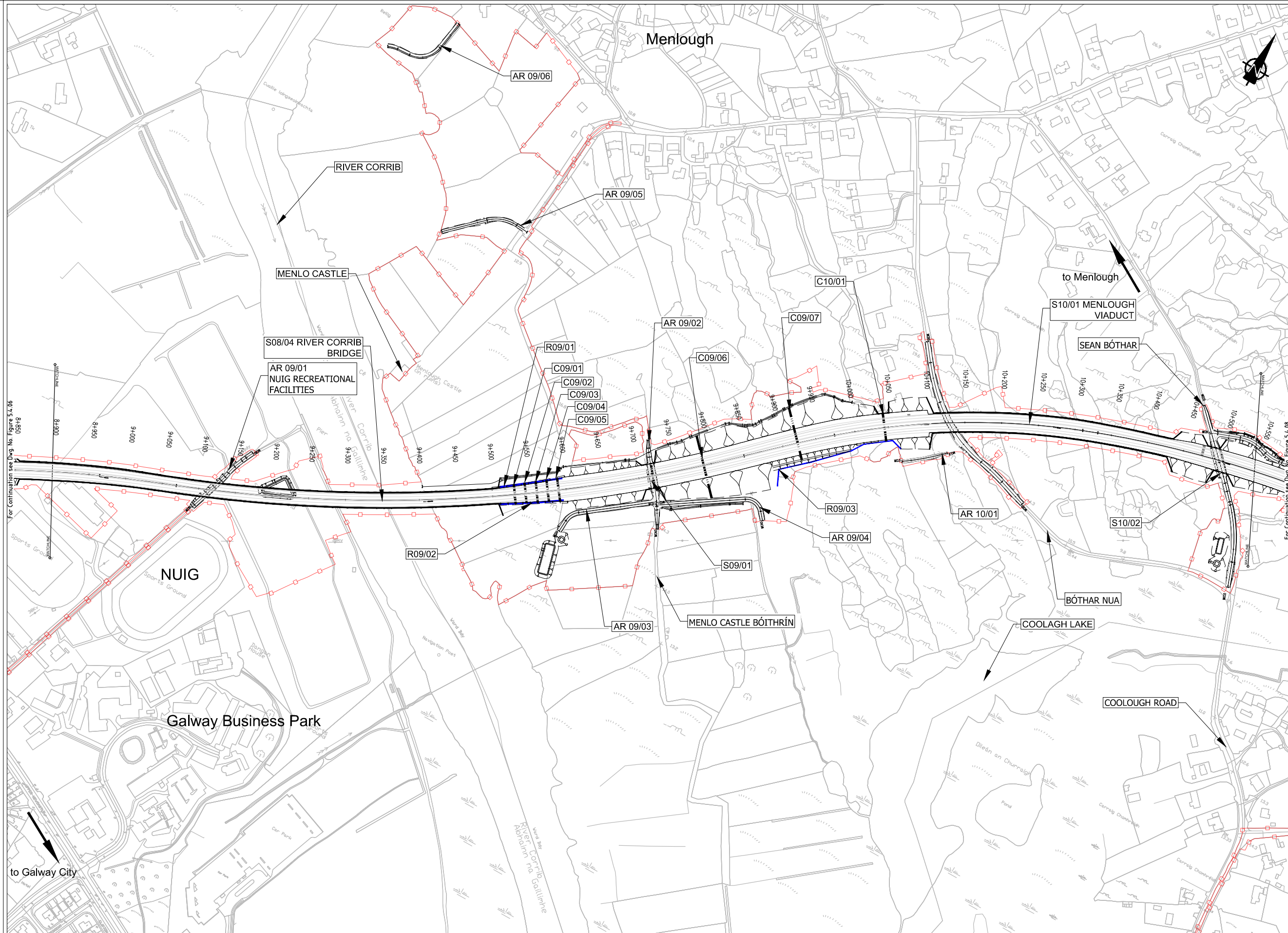

- Legend:**
- City Boundary
  - Proposed Development Boundary
  - Proposed Road Development
  - Structure (S)
  - Proposed Culvert (C)
  - Proposed Mammel Underpass (C)
  - Proposed Attenuation Pond / Infiltration Basin / Wetlands
  - Proposed Stream Diversion
- Proposed Road Lighting**
- Lantern Type A  
9430 lm LED mounted on 10m high columns
  - Lantern Type B  
5410 lm LED mounted on 10m high columns
  - Lantern Type C  
5410 lm LED mounted on 10m high columns
  - Lantern Type D  
11760 lm LED mounted on 12m high columns
  - Floodlight Type E  
9380 lm LED mounted at 6m
- Proposed Road Lighting Isolines**
- Isoline 1.0 lux
  - Isoline 2.0 lux
  - Isoline 5.0 lux
  - Isoline 10 lux
  - Isoline 15 lux
  - Isoline 25 lux
- AR** AR - Access Road
- R** R - Retaining Wall

For Continuation see Dwg. No. Figure 5.4.06 05818

For Continuation see Dwg. No. Figure 5.4.08

Son áiríomh tá sonraíocht Shairbhéireacht Ordnáis Éireann arna aistriú go dtí físeán OSI Uimh. 2010/20CCMA/Comhairle Contae na Gaillimhe. Sáráilíon aistriú go dtí na n-áiríomh na císcheart Shairbhéireacht Ordnáis Éireann agus Rialtas na hÉireann. © Sairbhéireacht Ordnáis Éireann, 2010.

© Sairbhéireacht Ordnáis Éireann. Gach ceart ar chosaint. Uimhir cheadnáis 2010/20CCMA/Comhairle Contae na Gaillimhe.

Includes Ordnance Survey Ireland data reproduced under OSI Licence number 2010/20CCMA/Galway County Council. Unauthorised reproduction infringes Ordnance Survey Ireland and Government of Ireland copyright. © Ordnance Survey Ireland, 2010.

© Ordnance Survey Ireland. All rights reserved. Licence number 2010/20CCMA/Galway County Council.

Clients

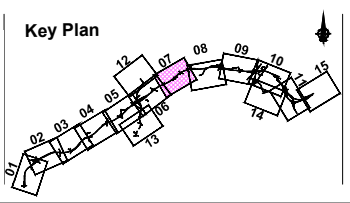

Consultant

Corporate House  
City East Business Park  
Ballybrit, Galway, Ireland.

Tel +353 (0)91 460675  
www.N6GalwayCity.ie  
www.arup.ie

Job Title  
**N6 Galway City Ring Road**

Scale  
1:5000 @ A3

Date:  
September 2018

Issue	Date	By	Chkd	Appd
I2	10/02/2020	KJ	HK	EMC
I1	28/09/2018	KJ	JD	EMC

Drawing Title  
**Road Lighting Columns and Brackets Location**  
CH.8+900 to CH.10+550  
Sheet 7 of 15

Drawing Status  
**For Information**

Job No  
**233985**

Drawing No  
**Figure 5.4.07**

Issue  
**I2**



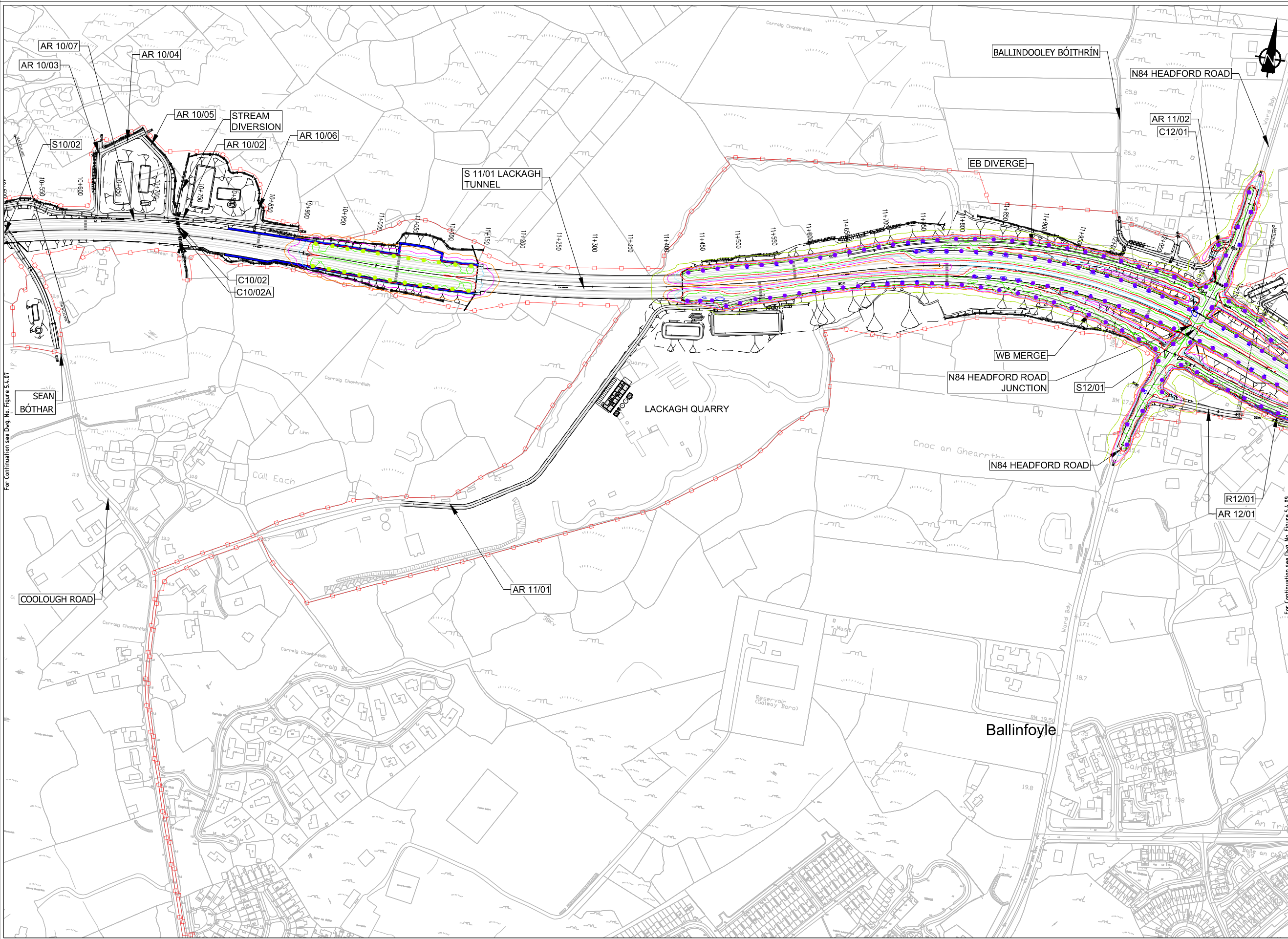

- Legend:**
- City Boundary
  - Proposed Development Boundary
  - Proposed Road Development
  - Structure (S)
  - Proposed Culvert (C)
  - Proposed Mammal Underpass (C)
  - Proposed Attenuation Pond / Infiltration Basin / Wetlands
  - Proposed Stream Diversion
- Proposed Road Lighting**
- Lantern Type A  
9430 lm LED mounted on 10m high columns
  - Lantern Type B  
5410 lm LED mounted on 10m high columns
  - Lantern Type C  
5410 lm LED mounted on 10m high columns
  - Lantern Type D  
11760 lm LED mounted on 12m high columns
  - Floodlight Type E  
9380 lm LED mounted at 6m
- Proposed Road Lighting Isolines**
- Isoline 1.0 lux
  - Isoline 2.0 lux
  - Isoline 5.0 lux
  - Isoline 10 lux
  - Isoline 15 lux
  - Isoline 25 lux
- AR** AR - Access Road
- R** R - Retaining Wall

For Continuation see Dwg No. Figure 5.4.07

For Continuation see Dwg No. Figure 5.4.09

Son áirímhé tá sonraíocht Shuirbhíreachtú Ordoanáis Éireann arna aistriú go dtí físeán Ceoláras OSI Uimh. 2010/20CCMA/Comhairle Contae na Gaillimhe. Sáráilíon aistriú go dtí na neamháráilíocht cóipeacht Shuirbhíreachtú Ordoanáis Éireann agus Rialtas na hÉireann. © Suirbhíreachtú Ordoanáis Éireann, 2010.

© Suirbhíreachtú Ordoanáis Éireann. Gach ceart ar chosaint. Uimhir cheadnáis 2010/20CCMA/Comhairle Contae na Gaillimhe.

Includes Ordnance Survey Ireland data reproduced under OSI Licence number 2010/20CCMA/Galway County Council. Unauthorised reproduction infringes Ordnance Survey Ireland and Government of Ireland copyright. © Ordnance Survey Ireland, 2010.

© Ordnance Survey Ireland. All rights reserved. Licence number 2010/20CCMA/Galway County Council.

Clients

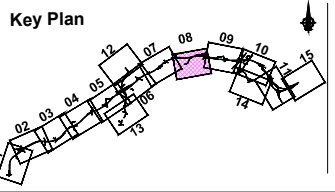

Consultant

Corporate House  
City East Business Park  
Ballybrit, Galway, Ireland.

Tel +353 (0)91 460675  
www.N6GalwayCity.ie  
www.arup.ie

Job Title  
**N6 Galway City Ring Road**

Scale  
1:5000 @ A3

Date  
September 2018

Issue	Date	By	Chkd	Appd
I2	10/02/2020	KJ	HK	EMC
I1	28/09/2018	KJ	JD	EMC

Drawing Title  
**Road Lighting Columns and Brackets Location CH.10+550 to CH.12+200**

Sheet 8 of 15

Drawing Status  
**For Information**

Job No <b>233985</b>	Drawing No <b>Figure 5.4.08</b>	Issue <b>12</b>
-------------------------	------------------------------------	--------------------



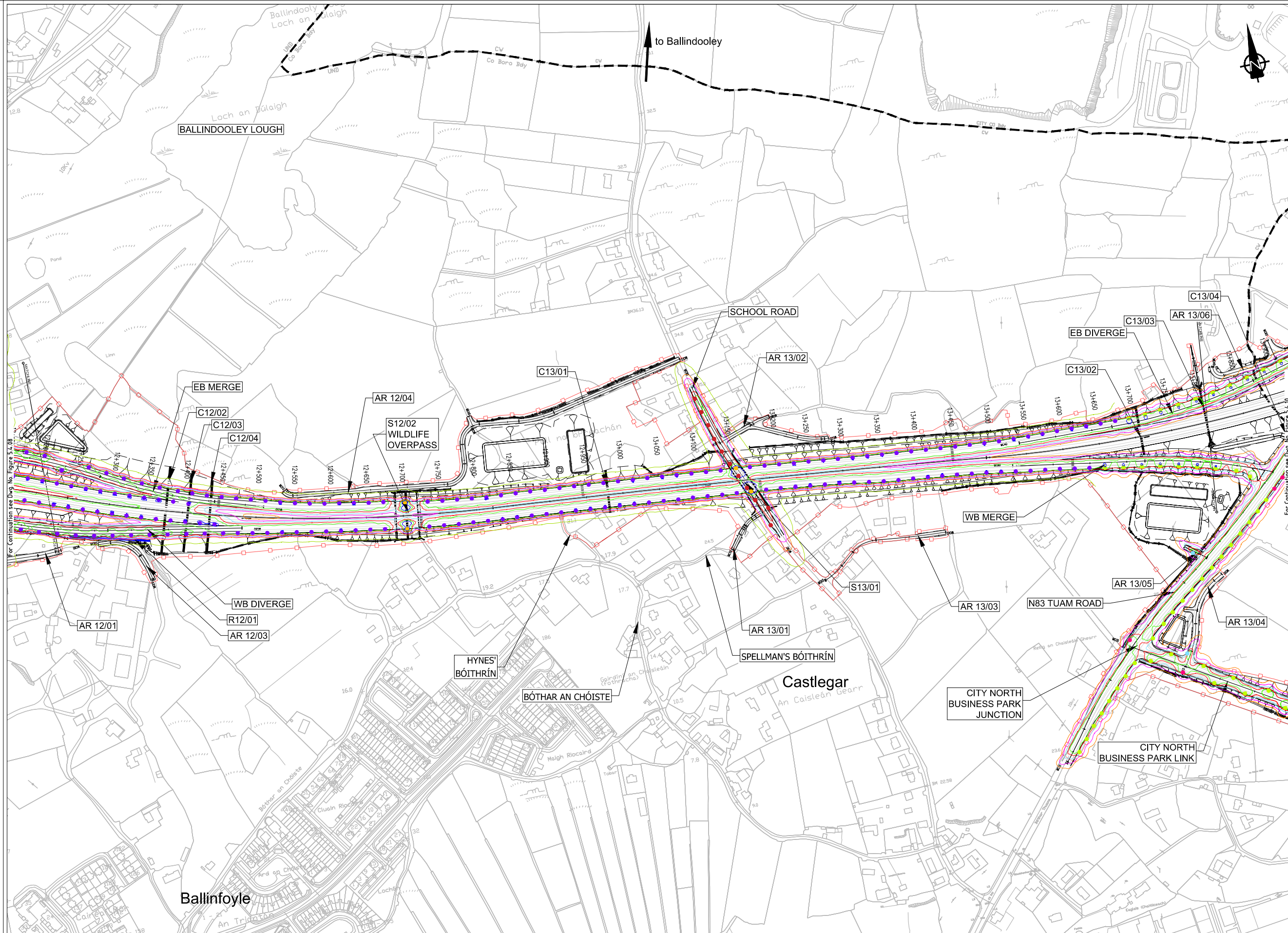

- Legend:**
- City Boundary
  - Proposed Development Boundary
  - Proposed Road Development
  - Structure (S)
  - Proposed Culvert (C)
  - Proposed Mammal Underpass (C)
  - Proposed Attenuation Pond / Infiltration Basin / Wetlands
  - Proposed Stream Diversion
- Proposed Road Lighting**
- Lantern Type A  
9430 lm LED mounted on 10m high columns
  - Lantern Type B  
5410 lm LED mounted on 10m high columns
  - Lantern Type C  
5410 lm LED mounted on 10m high columns
  - Lantern Type D  
11760 lm LED mounted on 12m high columns
  - Floodlight Type E  
9380 lm LED mounted at 6m
- Proposed Road Lighting Isolines**
- Isoline 1.0 lux
  - Isoline 2.0 lux
  - Isoline 5.0 lux
  - Isoline 10 lux
  - Isoline 15 lux
  - Isoline 25 lux
- AR** - Access Road  
**R** - Retaining Wall

Son áiríúmh tá sonraíocht Shuirbhíreachtú Ordnáis Éireann arna aistriúgeadh fíú Cheadúnas OSI Uimh. 2010/20CCMA/Comhairle Contae na Gaillimhe. Sárúinn aistriúgeadh neamhdáraithe cóipeacht Shuirbhíreachtú Ordnáis Éireann agus Rialtas na hÉireann. © Suirbhíreachtú Ordnáis Éireann, 2010.

© Suirbhíreachtú Ordnáis Éireann. Gach ceart ar chosaint. Uimhir cheadúnais 2010/20CCMA/Comhairle Contae na Gaillimhe. Includes Ordnance Survey Ireland data reproduced under OSI Licence number 2010/20CCMA/Galway County Council. Unauthorised reproduction infringes Ordnance Survey Ireland and Government of Ireland copyright. © Ordnance Survey Ireland, 2010.

© Ordnance Survey Ireland. All rights reserved. Licence number 2010/20CCMA/Galway County Council.

Clients

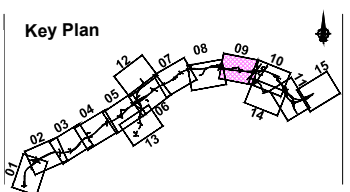

Consultant

Corporate House  
City East Business Park  
Ballybrit, Galway, Ireland.

Tel +353 (0)91 460675  
www.N6GalwayCity.ie  
www.arup.ie

Job Title  
**N6 Galway City Ring Road**

Scale  
1:5000 @ A3

Date:  
September 2018

Issue	Date	By	Chkd	Appd
I2	10/02/2020	KJ	HK	EMC
I1	28/09/2018	KJ	JD	EMC

Drawing Title  
**Road Lighting Columns and Brackets Location  
CH.12+200 to CH.13+800  
Sheet 9 of 15**

Drawing Status  
**For Information**

Job No  
**233985**

Drawing No  
**Figure 5.4.09**

Issue  
**12**



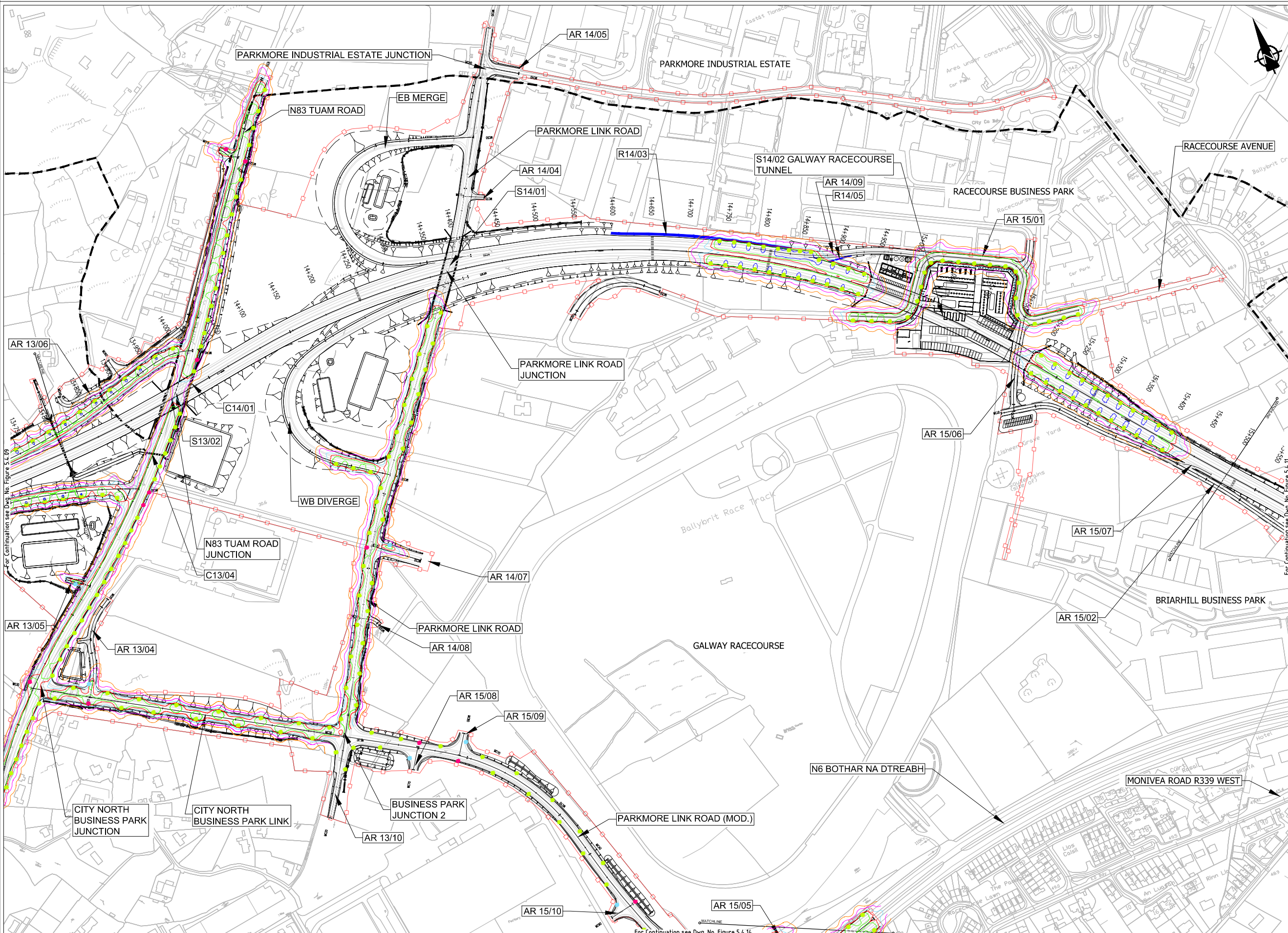

- Legend:**
- City Boundary
  - Proposed Development Boundary
  - Proposed Road Development
  - Structure (S)
  - Proposed Culvert (C)
  - Proposed Mammal Underpass (C)
  - Proposed Attenuation Pond / Infiltration Basin / Wetlands
  - Proposed Stream Diversion
- Proposed Road Lighting**
- Lantern Type A  
9430 lm LED mounted on 10m high columns
  - Lantern Type B  
5410 lm LED mounted on 10m high columns
  - Lantern Type C  
5410 lm LED mounted on 10m high columns
  - Lantern Type D  
11760 lm LED mounted on 12m high columns
  - Floodlight Type E  
9380 lm LED mounted at 6m
- Proposed Road Lighting Isolines**
- Isoline 1.0 lux
  - Isoline 2.0 lux
  - Isoline 5.0 lux
  - Isoline 10 lux
  - Isoline 15 lux
  - Isoline 25 lux
- AR** AR - Access Road
- R** R - Retaining Wall

Son áiríamh tá sonraíocht Shairbhéiríocht Ordánais Éireann arna aistriú go dtailéad físe Chéadúnaí OSI Uimh. 2010/20CCMA/Comhairle Contae na Gaillimhe. Sárúilíon aistriú go dtailéad físe cíoscheart Shairbhéiríocht Ordánais Éireann agus Rialtas na hÉireann. © Sairbhéiríocht Ordánais Éireann, 2010.

© Sairbhéiríocht Ordánais Éireann. Gach ceart ar chosaint. Uimhir cheadúnaí 2010/20CCMA/Comhairle Contae na Gaillimhe.

Includes Ordnance Survey Ireland data reproduced under OSI Licence number 2010/20CCMA/Galway County Council. Unauthorised reproduction infringes Ordnance Survey Ireland and Government of Ireland copyright. © Ordnance Survey Ireland, 2010.

© Ordnance Survey Ireland. All rights reserved. Licence number 2010/20CCMA/Galway County Council.

Clients

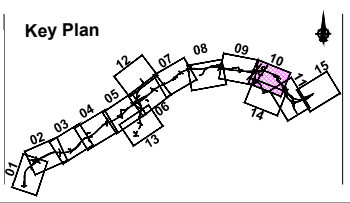

Consultant

Corporate House  
City East Business Park  
Ballybrit, Galway, Ireland.

Tel +353 (0)91 460675  
www.N6GalwayCity.ie  
www.arup.ie

Job Title  
**N6 Galway City Ring Road**

Scale  
1:5000 @ A3

Date:  
September 2018

Issue	Date	By	Chkd	Appd
I2	10/02/2020	KJ	HK	EMC
I1	28/09/2018	KJ	JD	EMC

Drawing Title  
**Road Lighting Columns and Brackets Location CH.13+800 to CH.15+500**

Sheet 10 of 15

Drawing Status  
**For Information**

Job No  
**233985**

Drawing No  
**Figure 5.4.10**

Issue  
**I2**



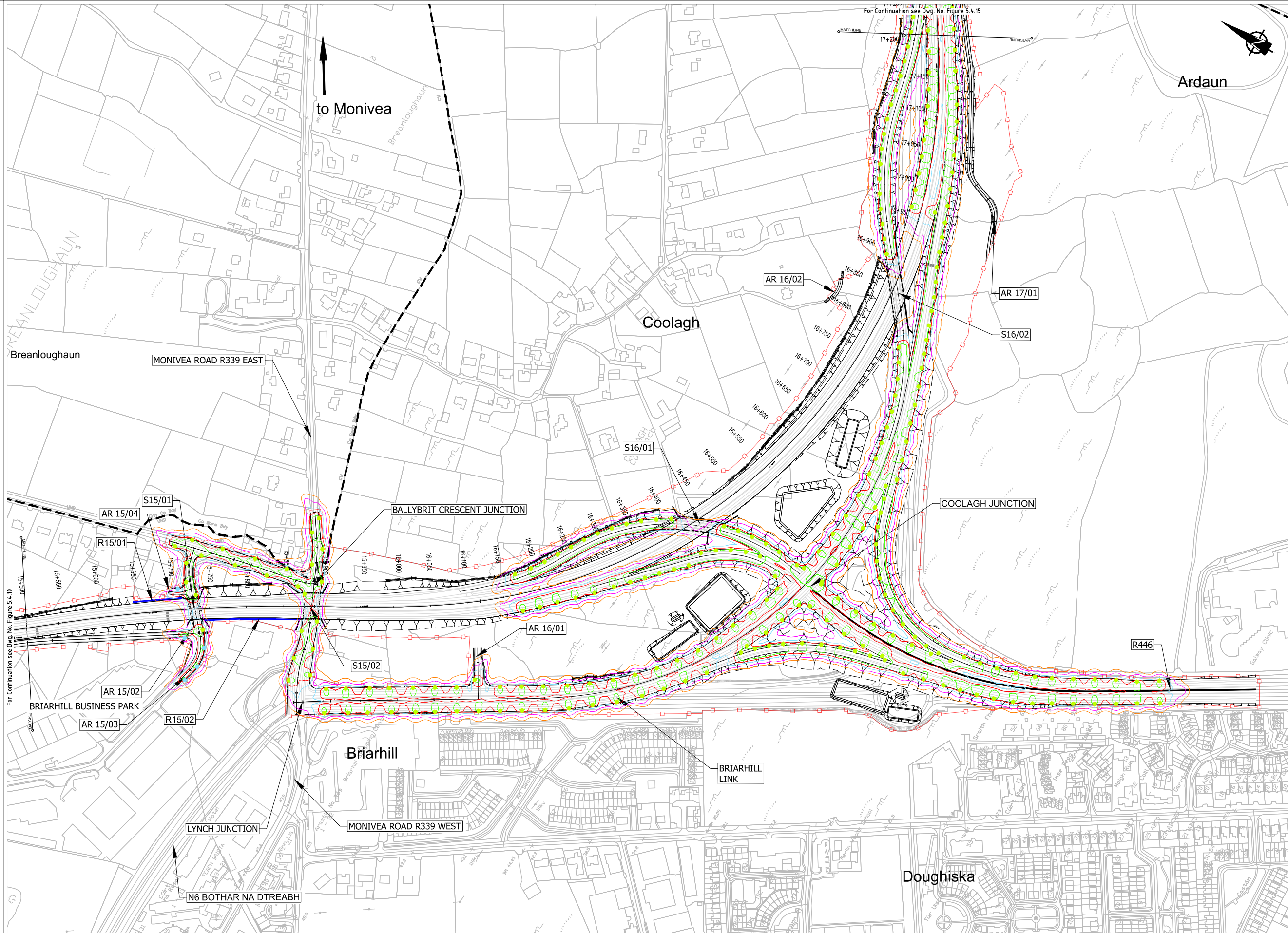

**EIA REPORT**

**Legend:**

- City Boundary
- Proposed Development Boundary
- Proposed Road Development
- Structure (S)
- Proposed Culvert (C)
- Proposed Mammal Underpass (C)
- Proposed Attenuation Pond / Infiltration Basin / Wetlands
- Proposed Stream Diversion

**Proposed Road Lighting**

- Lantern Type A: 9430 lm LED mounted on 10m high columns
- Lantern Type B: 5410 lm LED mounted on 10m high columns
- Lantern Type C: 5410 lm LED mounted on 10m high columns
- Lantern Type D: 11760 lm LED mounted on 12m high columns
- Floodlight Type E: 9380 lm LED mounted at 6m

**Proposed Road Lighting Isolines**

- Isoline 1.0 lux
- Isoline 2.0 lux
- Isoline 5.0 lux
- Isoline 10 lux
- Isoline 15 lux
- Isoline 25 lux

**AR** - Access Road  
**R** - Retaining Wall

San áiríúmh tá sonraíocht Shuirbhíreacht Ordnáis Éireann arna aistriú go dtailíú físe Chaidéas OSI Uimh. 2010/20CCMA/Comhairle Contae na Gaillimhe. Sárú ar na sonraíocht neamhdáraithe cóipeacht Shuirbhíreacht Ordnáis Éireann agus Rialtas na hÉireann. © Suirbhíreacht Ordnáis Éireann, 2010.

© Suirbhíreacht Ordnáis Éireann. Gach ceart ar chosaint. Uimhir cheadnáis 2010/20CCMA/Comhairle Contae na Gaillimhe.

Includes Ordnance Survey Ireland data reproduced under OSI Licence number 2010/20CCMA/Galway County Council. Unauthorised reproduction infringes Ordnance Survey Ireland and Government of Ireland copyright. © Ordnance Survey Ireland, 2010.

© Ordnance Survey Ireland. All rights reserved. Licence number 2010/20CCMA/Galway County Council.

Clients

An Roinn Iompair Turasoireachta agus Spóirt  
Department Transport, Tourism and Sport

Project Ireland 2040  
The New Normal

Galway City Transport Project

Comhairle Chontae na Gaillimhe  
Galway County Council

TIU  
Transport Infrastructure Unit

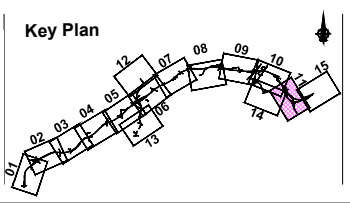

Consultant

**ARUP**

Corporate House  
City East Business Park  
Ballybrit, Galway, Ireland.

Tel +353 (0)91 460675  
www.N6GalwayCity.ie  
www.arup.ie

Job Title  
**N6 Galway City Ring Road**

Scale  
1:5000 @ A3

Date:  
September 2018

Issue	Date	By	Chkd	Appd
I2	10/02/2020	KJ	HK	EMC
I1	28/09/2018	KJ	JD	EMC

Drawing Title  
Road Lighting Columns and Brackets Location  
CH.15+500 to CH.17+200  
Sheet 11 of 15

Drawing Status  
**For Information**

Job No  
**233985**

Drawing No  
**Figure 5.4.11**

Issue  
**I2**



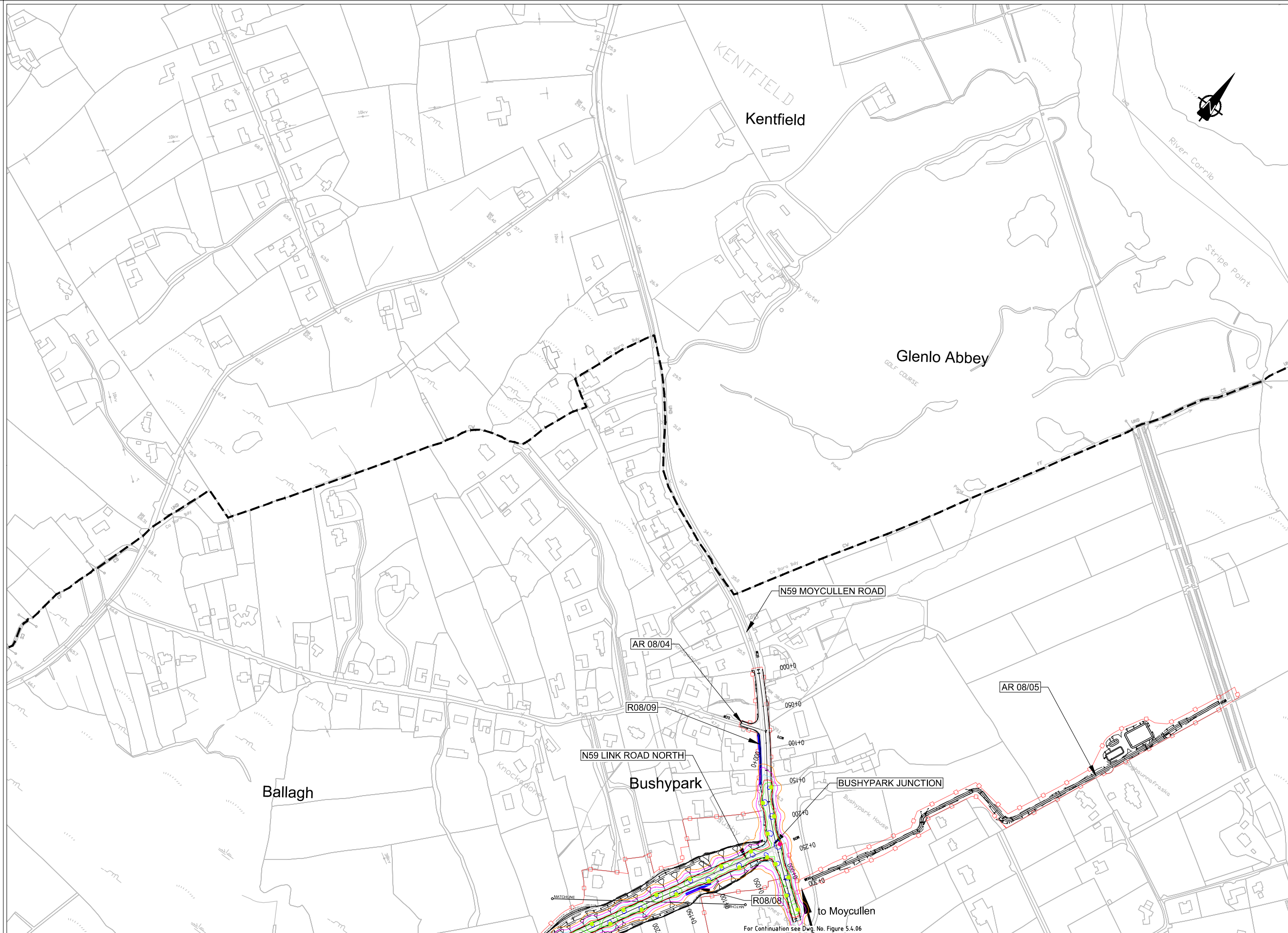

- Legend:**
- City Boundary
  - Proposed Development Boundary
  - Proposed Road Development
  - Structure (S)
  - Proposed Culvert (C)
  - Proposed Mammal Underpass (C)
  - Proposed Attenuation Pond / Infiltration Basin / Wetlands
  - Proposed Stream Diversion
- Proposed Road Lighting**
- Lantern Type A  
9430 lm LED mounted on 10m high columns
  - Lantern Type B  
5410 lm LED mounted on 10m high columns
  - Lantern Type C  
5410 lm LED mounted on 10m high columns
  - Lantern Type D  
11760 lm LED mounted on 12m high columns
  - Floodlight Type E  
9380 lm LED mounted at 6m
- Proposed Road Lighting Isolines**
- Isoline 1.0 lux
  - Isoline 2.0 lux
  - Isoline 5.0 lux
  - Isoline 10 lux
  - Isoline 15 lux
  - Isoline 25 lux
- AR** AR - Access Road  
**R** R - Retaining Wall

Son áiríamh tá sonraíocht Shuirbhíreachtú Ordnáis Éireann arna aistriú go dtí físeán OSI Uimh. 2010/20CCMA/Comhairle Contae na Gaillimhe. Sáráilom aistriú go dtí na neamháráilte cíoscheart Shuirbhíreachtú Ordnáis Éireann agus Rialtas na hÉireann. © Suirbhíreachtú Ordnáis Éireann, 2010.

© Suirbhíreachtú Ordnáis Éireann. Gach ceart ar chosaint. Uimhir cheadnáis 2010/20CCMA/Comhairle Contae na Gaillimhe.

Includes Ordnance Survey Ireland data reproduced under OSI Licence number 2010/20CCMA/Galway County Council. Unauthorised reproduction infringes Ordnance Survey Ireland and Government of Ireland copyright. © Ordnance Survey Ireland, 2010.

© Ordnance Survey Ireland. All rights reserved. Licence number 2010/20CCMA/Galway County Council.

Clients

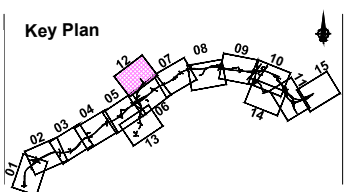

Consultant

Corporate House  
City East Business Park  
Ballybrit, Galway, Ireland.

Tel +353 (0)91 460675  
www.N6GalwayCity.ie  
www.arup.ie

Job Title  
**N6 Galway City Ring Road**

Scale  
1:5000 @ A3

Date:  
September 2018

Issue	Date	By	Chkd	Appd
I2	10/02/2020	KJ	HK	EMC
I1	28/09/2018	KJ	JD	EMC

Drawing Title  
**Road Lighting Columns and Brackets Location N59 Link Road North**

Sheet 12 of 15

Drawing Status  
**For Information**

Job No  
**233985**

Drawing No  
**Figure 5.4.12**

Issue  
**12**



- Legend:**
- City Boundary
  - Proposed Development Boundary
  - Proposed Road Development
  - Structure (S)
  - Proposed Culvert (C)
  - Proposed Mammel Underpass (C)
  - Proposed Attenuation Pond / Infiltration Basin / Wetlands
  - Proposed Stream Diversion
- Proposed Road Lighting**
- Lantern Type A  
9430 lm LED mounted on 10m high columns
  - Lantern Type B  
5410 lm LED mounted on 10m high columns
  - Lantern Type C  
5410 lm LED mounted on 10m high columns
  - Lantern Type D  
11760 lm LED mounted on 12m high columns
  - Floodlight Type E  
9380 lm LED mounted at 6m
- Proposed Road Lighting Isolines**
- Isoline 1.0 lux
  - Isoline 2.0 lux
  - Isoline 5.0 lux
  - Isoline 10 lux
  - Isoline 15 lux
  - Isoline 25 lux
- AR** AR - Access Road
- R** R - Retaining Wall

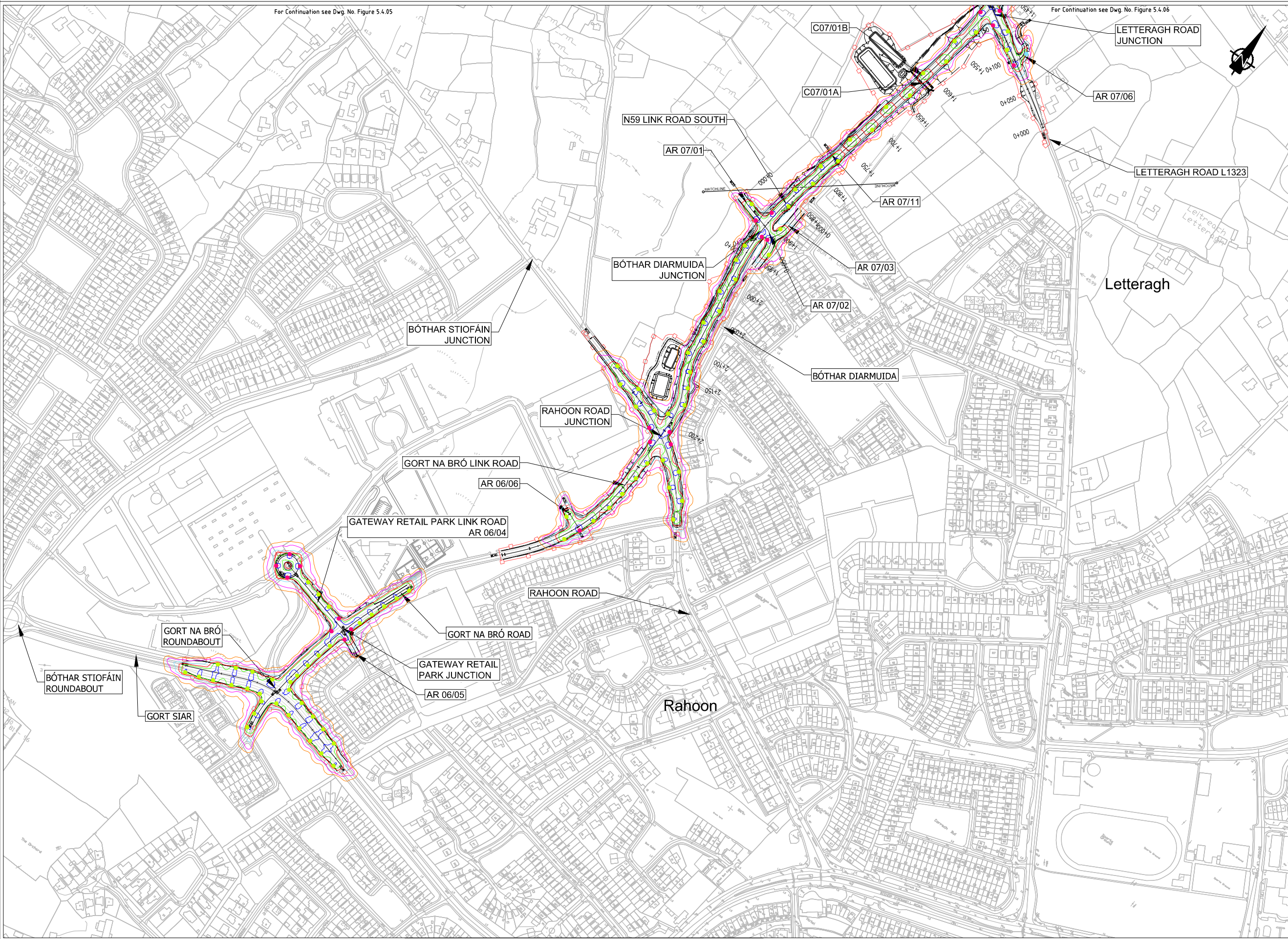

Son áiríamh tá sonraíocht Shairbhéireacht Ordnáis Éireann arna aistriú go dtí físeán OSI Uimh. 2010/20CCMA/Comhairle Contae na Gaillimhe. Sáráilíon aistriú go dtí neamhádaraithe cóipeacht Shairbhéireacht Ordnáis Éireann agus Rialtas na hÉireann. © Sairbhéireacht Ordnáis Éireann, 2010.

© Sairbhéireacht Ordnáis Éireann. Gach ceart ar chosaint. Uimhir cheadúnais 2010/20CCMA/Comhairle Contae na Gaillimhe.

Includes Ordnance Survey Ireland data reproduced under OSI Licence number 2010/20CCMA/Galway County Council. Unauthorised reproduction infringes Ordnance Survey Ireland and Government of Ireland copyright. © Ordnance Survey Ireland, 2010.

© Ordnance Survey Ireland. All rights reserved. Licence number 2010/20CCMA/Galway County Council.

Clients

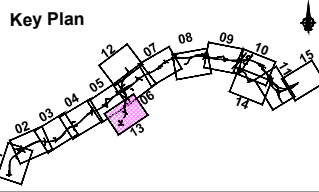

Consultant

Corporate House  
City East Business Park  
Ballybrit, Galway, Ireland.

Tel +353 (0)91 460675  
www.N6GalwayCity.ie  
www.arup.ie

Job Title  
**N6 Galway City Ring Road**

Scale  
1:5000 @ A3

Date:  
September 2018

Issue	Date	By	Chkd	Appd
I2	10/02/2020	KJ	HK	EMC
I1	28/09/2018	KJ	JD	EMC

Drawing Title  
**Road Lighting Columns and Brackets Location N59 Link Road South**

Sheet 13 of 15

Drawing Status  
**For Information**

Job No  
**233985**

Drawing No  
**Figure 5.4.13**

Issue  
**I2**



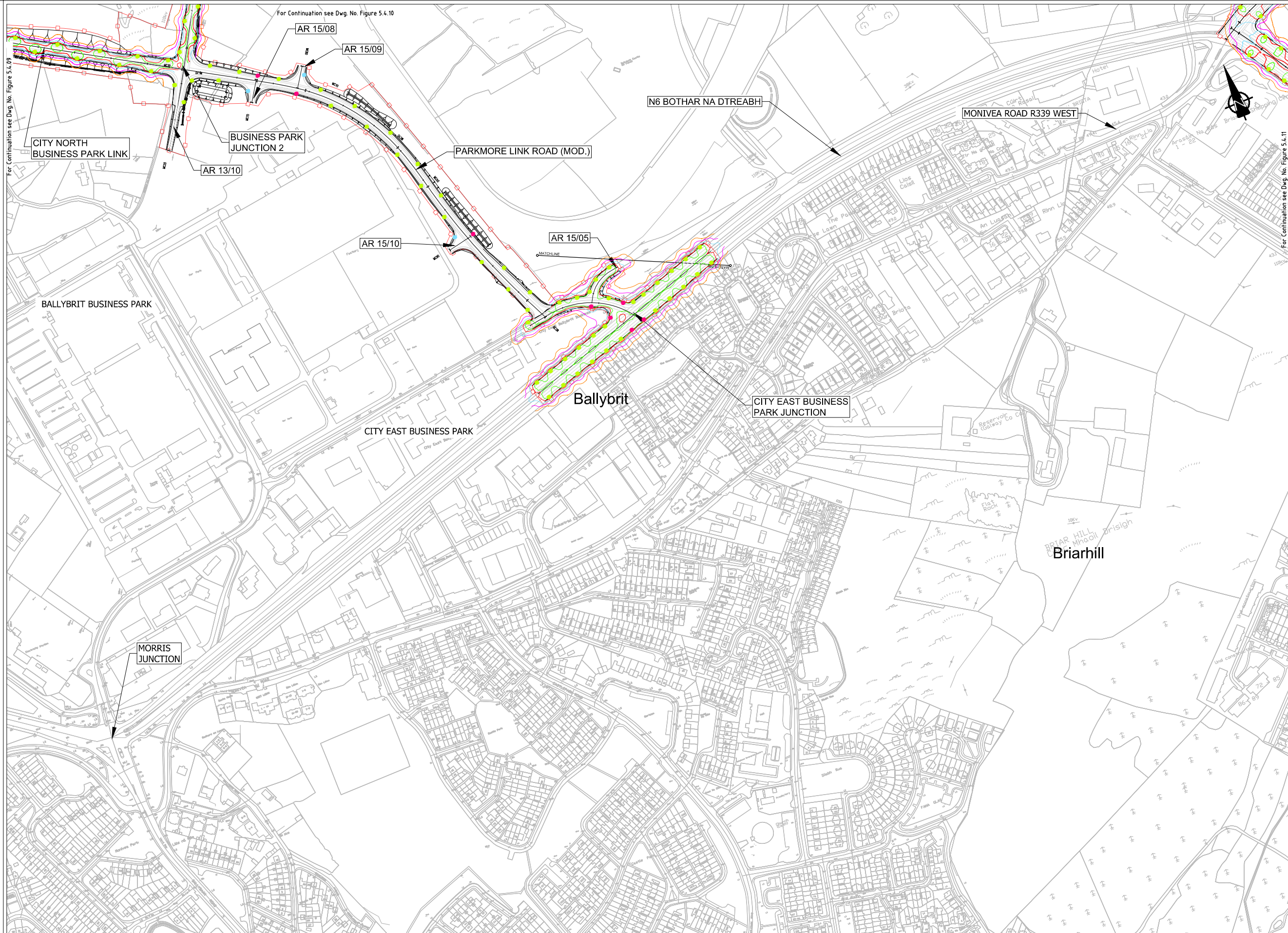

**EIA REPORT**

**Legend:**

- City Boundary
- Proposed Development Boundary
- Proposed Road Development
- Structure (S)
- Proposed Culvert (C)
- Proposed Mammal Underpass (C)
- Proposed Attenuation Pond / Infiltration Basin / Wetlands
- Proposed Stream Diversion

**Proposed Road Lighting**

- Lantern Type A: 9430 lm LED mounted on 10m high columns
- Lantern Type B: 5410 lm LED mounted on 10m high columns
- Lantern Type C: 5410 lm LED mounted on 10m high columns
- Lantern Type D: 11760 lm LED mounted on 12m high columns
- Floodlight Type E: 9380 lm LED mounted at 6m

**Proposed Road Lighting Isolines**

- Isoline 1.0 lux
- Isoline 2.0 lux
- Isoline 5.0 lux
- Isoline 10 lux
- Isoline 15 lux
- Isoline 25 lux

**AR** - Access Road  
**R** - Retaining Wall

Son áiríúmh tá sonraíocht Shuirbhéiríochta Ordánais Éireann arna aistriúgeadh fíor Cheadúnas OSI Uimh. 2010/20CCMA/Comhairle Contae na Gaillimhe. Sárúilíon aistriúgeadh neamhdáraithe cóipeacht Shuirbhéiríochta Ordánais Éireann agus Rialtas na hÉireann. © Suirbhéiríochta Ordánais Éireann, 2010.

© Suirbhéiríochta Ordánais Éireann. Gach ceart ar chosaint. Uimhir cheadúnais 2010/20CCMA/Comhairle Contae na Gaillimhe.

Includes Ordnance Survey Ireland data reproduced under OSI Licence number 2010/20CCMA/Galway County Council. Unauthorised reproduction infringes Ordnance Survey Ireland and Government of Ireland copyright. © Ordnance Survey Ireland, 2010.

© Ordnance Survey Ireland. All rights reserved. Licence number 2010/20CCMA/Galway County Council.

Clients

An Roinn Iompair Turasoíreachta agus Spóirt  
 Department Transport, Tourism and Sport

Project Ireland 2040  
 The National Development Plan

Galway City Transport Project

Comhairle Chontae na Gaillimhe  
 Galway County Council

TIU  
 Transport Infrastructure Unit

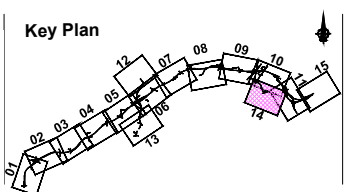

Consultant

**ARUP**

Corporate House  
 City East Business Park  
 Ballybrit, Galway, Ireland.

Tel +353 (0)91 460675  
 www.N6GalwayCity.ie  
 www.arup.ie

Job Title  
**N6 Galway City Ring Road**

Scale  
 1:5000 @ A3

Date:  
 September 2018

Issue	Date	By	Chkd	Appd
I2	10/02/2020	KJ	HK	EMC
I1	28/09/2018	KJ	JD	EMC

Drawing Title  
**Road Lighting Columns and Brackets Location  
 City East Junction**

Sheet 14 of 15

Drawing Status  
**For Information**

Job No  
**233985**

Drawing No  
**Figure 5.4.14**

Issue  
**12**



- Legend:**
- City Boundary
  - Proposed Development Boundary
  - Proposed Road Development
  - Structure (S)
  - Proposed Culvert (C)
  - Proposed Mammal Underpass (C)
  - Proposed Attenuation Pond / Infiltration Basin / Wetlands
  - Proposed Stream Diversion
- Proposed Road Lighting**
- Lantern Type A  
9430 lm LED mounted on 10m high columns
  - Lantern Type B  
5410 lm LED mounted on 10m high columns
  - Lantern Type C  
5410 lm LED mounted on 10m high columns
  - Lantern Type D  
11760 lm LED mounted on 12m high columns
  - Floodlight Type E  
9380 lm LED mounted at 6m
- Proposed Road Lighting Isolines**
- Isoline 1.0 lux
  - Isoline 2.0 lux
  - Isoline 5.0 lux
  - Isoline 10 lux
  - Isoline 15 lux
  - Isoline 25 lux
- AR** AR - Access Road
- R** R - Retaining Wall

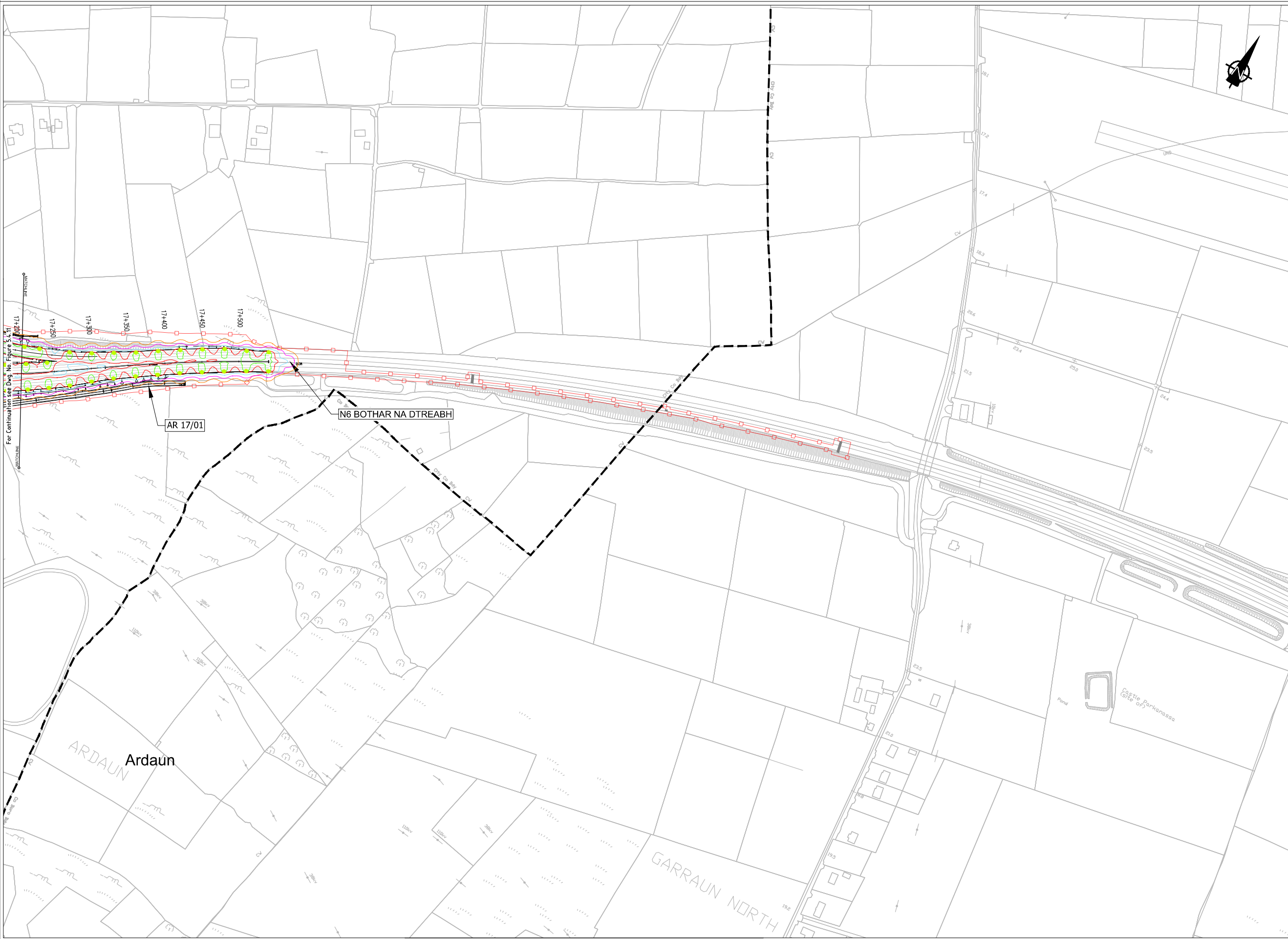

Sun áiríonn sé na sonraíochtaí Shuirbhéireacht Ordnáis Éireann arna aistriú go dtí físeán Ceardúnas OSI Uimh. 2010/20CCMA/Comhairle Contae na Gaillimhe. Sáráilonn aistriú go dtí neamháráil na cíoscheart Shuirbhéireacht Ordnáis Éireann agus Rialtas na hÉireann. © Suirbhéireacht Ordnáis Éireann, 2010.

© Suirbhéireacht Ordnáis Éireann. Gach ceart ar chosaint. Uimhir cheadúnais 2010/20CCMA/Comhairle Contae na Gaillimhe.

Includes Ordnance Survey Ireland data reproduced under OSI Licence number 2010/20CCMA/Galway County Council. Unauthorised reproduction infringes Ordnance Survey Ireland and Government of Ireland copyright. © Ordnance Survey Ireland, 2010.

© Ordnance Survey Ireland. All rights reserved. Licence number 2010/20CCMA/Galway County Council.

Clients

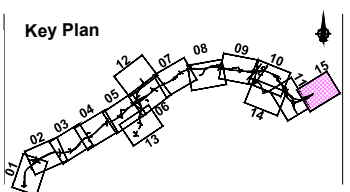

Consultant

Corporate House  
City East Business Park  
Ballybrit, Galway, Ireland.

Tel +353 (0)91 460675  
www.N6GalwayCity.ie  
www.arup.ie

Job Title  
**N6 Galway City Ring Road**

Scale  
1:5000 @ A3

Date:  
September 2018

Issue	Date	By	Chkd	Appd
I2	10/02/2020	KJ	HK	EMC
I1	28/09/2018	KJ	JD	EMC

Drawing Title  
**Road Lighting Columns and Brackets Location CH.17+200 (End of Scheme) to Existing N6 (-CH.18+550)**

Sheet 15 of 15

Drawing Status  
**For Information**

Job No <b>233985</b>	Drawing No <b>Figure 5.4.15</b>	Issue <b>I2</b>
-------------------------	------------------------------------	--------------------